

New Construction

900 American Road

Morris Plains, New Jersey



FOR LEASE

PROPERTY SPECS:

Available Space: Units of 5,000 SF with
625 SF office; up to 25,000 SF contiguous

Total Building Size: 54,576 SF (clear span)

Ceiling Height: 24' clear

Parking: 133 cars

Loading: 11 tailgate docks

Zoning: Light Industrial

Available: Immediately

Lease Rate: \$13.75 PSF NNN

Taxes & CAM: Estimated \$4.25 PSF

Mass Transit: Approximately one-half mile
to Morris Plains train station

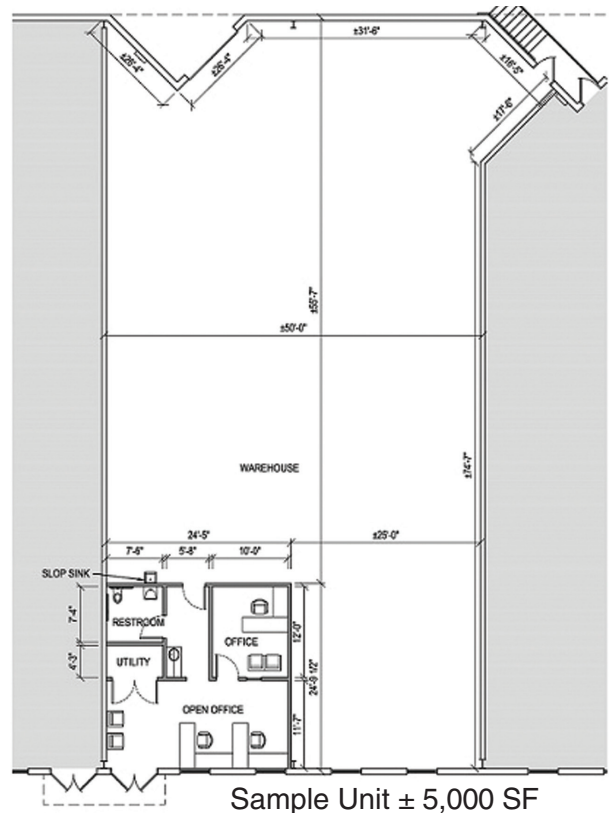

For more information, please contact:

Scott Peck, SIOR
speck@resource-realty.com

Gregory J. Sabato, SIOR
gsabato@resource-realty.com

Exclusive Leasing Agent:



Resource Realty
Corporate Real Estate Services



973-299-0900

www.resource-realty.com

FLOOR PLAN

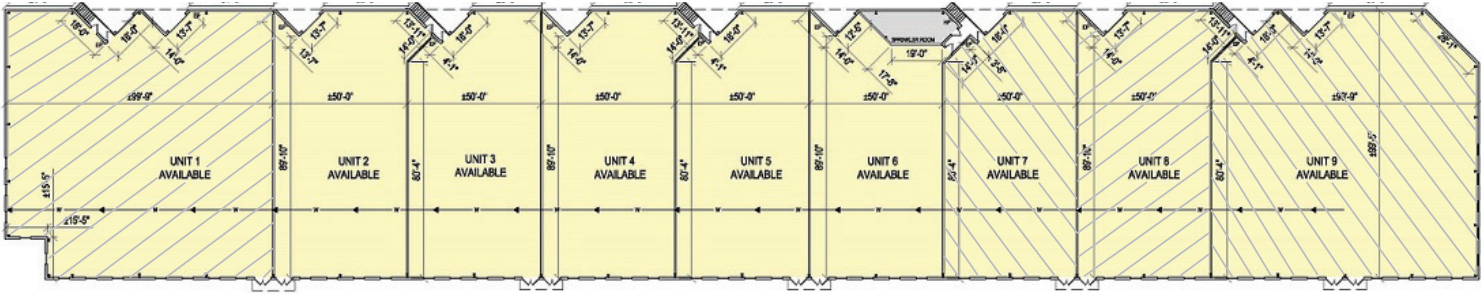

MAP



All information furnished is from sources deemed reliable. No representation is made as to the accuracy thereof and it is submitted subject to error, omission, change of price, prior sale or lease and withdrawal without notice. Any commission due cooperating brokers is subject to all of the terms and conditions upon which we and our clients have agreed.

Exclusive Leasing Agent:



973-299-0900
www.resource-realty.com